

Angular Contact Ball Bearings

Brass cage angular contact ball bearing-7248 BCBM

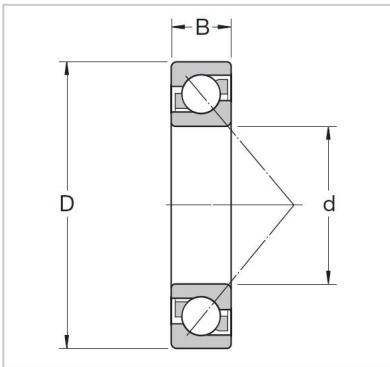

Abutment and fillet dimensions

Db max. **7248 BCBM**

Da max.

da min. 240

rb max. 440

ra max. **72**

Dimensions

a 364

r3,4 min. 540

r1,2 min 12.5

D1 1 600

d2 1 700

d1 49

Mass

KG 322

Speed ratings r/min

Limiting speed 292

Reference speed 361

Fatigue load limit

Pu kN **4**

Basic load ratings KN

dynamic C kN 1.5

static Co kN 180

Basic design bearing

B mm 257

D mm 423

d mm 431

Basic design bearing 3

Designations

Universally matchable bearing 1.5